

NAMB/WEST

NOVEMBER 14-18, 2008
EXHIBIT HALL OPEN NOVEMBER 18, 2008
MGM GRAND LAS VEGAS
PREMIER BALLROOM 309-317
LEVEL 3

REVISION DATE:
10/28/08 CW

BOOTH COUNT

Inventory as of 10/28/2008

Dimension	Size	Qty	SqFt
10'x10'	100	79	7,900
10'x20'	200	12	2,400
10'x30'	300	1	300
20'x20'	400	2	800
20'x30'	600	2	1,200
Totals:		96	12,600

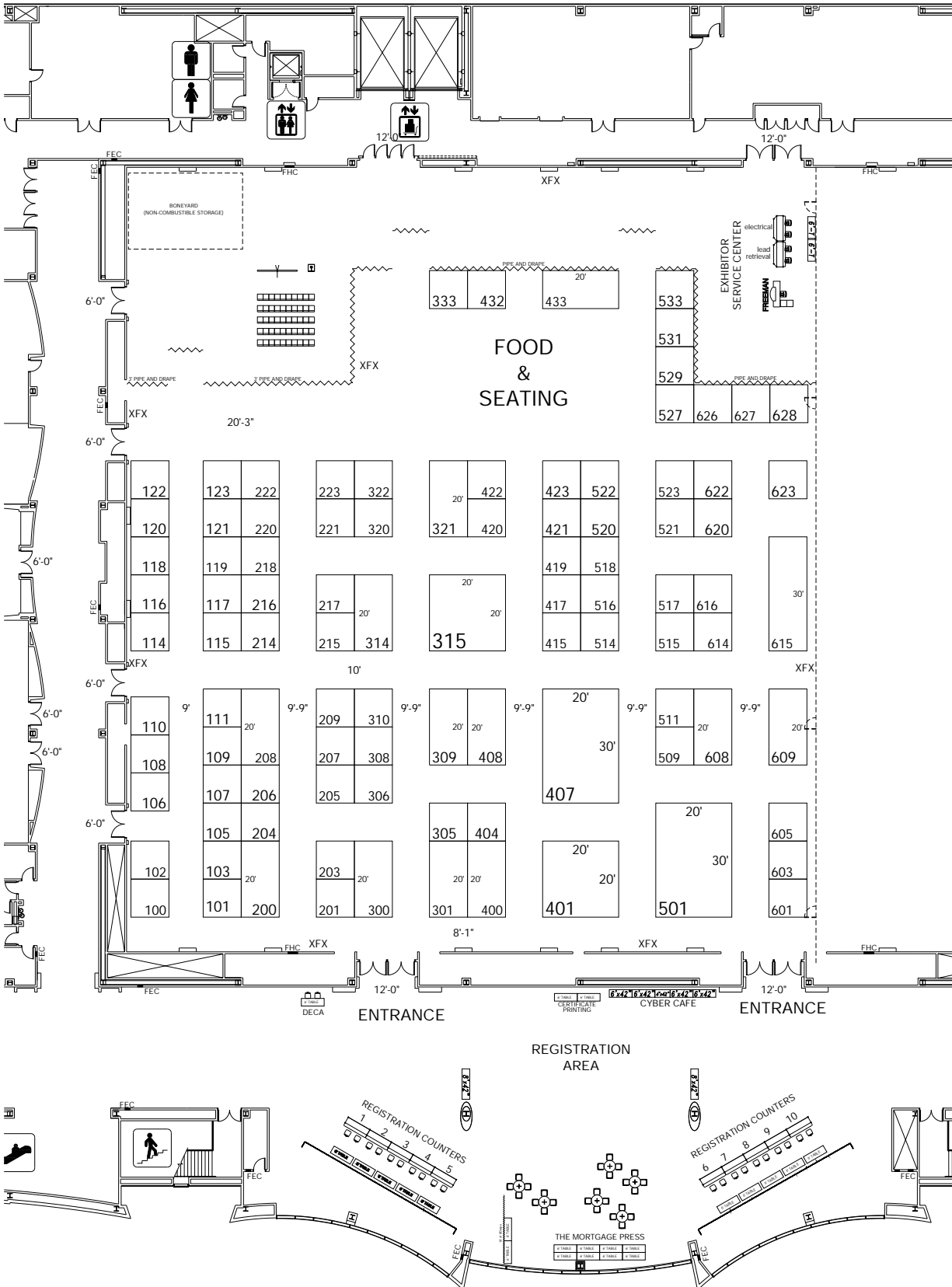

BLDG. LEGEND:

F R E E M A N

DRAWING STARTED:
7/18/2008 TA

FILE PATH:
O:\CAD\Shows08\11-November\NAMB
WEST

DRAWING NAME:
T-NAMBWEST-08 MGM LAS VEGAS MGM GRND PREMIER BLRM

JOB NUMBER:
218200

ACCT. EXEC.:
BILL BENNETT

NOT TO SCALE

DISCLAIMER

EVERY EFFORT HAS BEEN MADE TO ENSURE THE ACCURACY OF ALL INFORMATION CONTAINED ON THIS FLOORPLAN. HOWEVER NO WARRANTIES, EITHER EXPRESSED OR IMPLIED ARE MADE WITH RESPECT TO THIS FLOORPLAN. IF THE LOCATION OF BUILDING COLUMNS, UTILITIES OR OTHER ARCHITECTURAL COMPONENTS OF THE FACILITY IS A CONSIDERATION IN THE CONSTRUCTION OR USAGE OF AN EXHIBIT, IT IS THE SOLE RESPONSIBILITY OF THE EXHIBITOR TO PHYSICALLY INSPECT THE FACILITY TO VERIFY ALL DIMENSIONS AND LOCATIONS.

© COPYRIGHT 2007, FREEMAN CO.
ALL RIGHTS RESERVED.